

Injection resin super epoxy SE 800 seismic

Two component injection chemical anchor based on pure epoxy resin for high performance and structural applications.

Application Features

- Designed to anchor threaded rods (M8-M30) and rebar (Ø8-32 mm) in concrete
- Approval for post-installed rebar and cracked and non-cracked concrete, diamond drilled holes and C2 seismic performance

Material Specification

- For high loads
- No shrinkage
- High chemical and temperature resistance
- Used in cracked and non-cracked concrete
- Fire resistance classification
- Suitable for warmer/hot regions
- Ideal for diamond drilled holes
- Ideal for deep embedment installations
- Ideal for stud fixing in wood
- For areas with high chemical exposure (e. g. seasalt and swimming pools)
- ETA approved for seismic loads C2

Handling and Storage

- This product should be stored between +5°C and +25°C
- Avoid Direct Sunlight
- The shelf life of the product is 24 months from the manufacture date

Performance Details

Order Details

Content	Composite Mortar	Description	Article Number
385ml	Pure epoxy	EJOT Super Epoxy SE 800 SEISMIC	9570 000385
585ml	Pure epoxy	EJOT Super Epoxy SE 800 SEISMIC	9900 110611

Working and Hardening Times

Temperature 🌡️	Working Time 🕒	Hardening in Dry Weather 🕒☀️	Hardening in Wet Weather 🕒💧
5-9	2 hours	50 hours	100 hours
10-19	1.5 hours	30 hours	60 hours
20-29	30 minutes	10 hours	20 hours
30-39	20 minutes	6 hours	12 hours
40	12 minutes	4 minutes	8 hours

*Resin temperature must be at least 20°C
Full cure 24 hours
All specifications based on supplied mixer

NOTE: For details/questions please check with technical department.
For details please consult valid ETA document as mentioned above.



Suitability according to seismic performance category

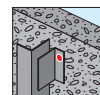

Certifications



ETA-15/0536

VOC classification A+

CONTAINS: BISPHENOL A-(EPICHLORHYDRIN) (REACTION PRODUCT); BISPHENOL-F EPICHLORHYDRIN RESIN; MW<700; 1,66-HEXANDIOLDIGLYCIDYLETHER; 3-AMINOMETHYL-3,5,5 TRIMETHYLCYCLOHEXYLAMINE; 2,2'-IMINODIETHYLAMINE; PHENOL; 1-3-BENZENEDIMETHANAMINE. Causes severe skin burns and eye damage. May cause an allergic skin reaction. Suspected of causing genetic defects. Toxic to aquatic life with long lasting effects. Do not handle until all safety precautions have been read and understood. Wash skin thoroughly after handling. Wear protective gloves / protective clothing / eye protection / face protection. IF IN EYES: Rinse cautiously with water for several minutes. Remove contact lenses, if present and easy to do. Continue rinsing. If exposed or concerned: Get medical advice / attention.