

# EJOT® COLORFAST® stainless steel bi-met self-drilling fasteners

## COLORFAST CF15/19/29 JT3-D-12H-5.5/6.3 x L range



A2 stainless steel bi-met high thread fastener for fixing insulated composite panels to hot rolled steel sections.

### Application Features

- Steel profile insulated composite panels to hot rolled steel sections 4.0mm - 12.0mm in thickness
- Available head options CF15, CF19 and CF29 aluminium/EPDM vulcanised sealing washers
- CF15 washered variants can be used in conjunction with the EJOT trapezoidal and sinusoidal storm washers



### Material Specification

- High quality stainless steel grade A2 to ISO 3506, EN 1.4301 to ISO 10088, AISI 304
- Hardened carbon steel drill point and lead threads
- High impact resistant coloured nylon head. Resistant to temperatures from -40 °C to 120 °C. Colorfast nylon heads are combined with UV stabilisers to ensure maximum colour retention



### Performance Details

#### Ultimate Fastener Tensile Strength

Fastener Diameter	kN
5.5/6.3 x L	11.50 <sup>†</sup>

#### Ultimate Fastener Shear Strength

Fastener Diameter	kN
5.5/6.3 x L	7.50 <sup>†</sup>

<sup>†</sup>Ultimate value of low thread shown

#### Ultimate Pullout Load kN

Fastener Diameter	Nominal Steel Thickness (mm)					
	4.00	5.00	6.00	8.00	10.00	12.00
5.5/6.3 x L	9.00	11.50	-	-	-	-

\*Mode of failure for ultimate pullout from 5-6mm thickness plus steel is limited by the ultimate tensile strength of the fastener.

Figures based on tests from steel 4.0mm and thicker designated as grade S275 (BS EN 10025), minimum yield strength 275 N/mm<sup>2</sup>.

#### Ultimate Pullover Load kN

Washer Face	Nominal Steel Thickness (mm)		
	0.50	0.70	0.90
CF15 Head	5.10	5.75	6.00
CF19 Head	5.50	6.20	6.50

Figures based on use with R38 profile steel sheets with fastener located in valley of profile.

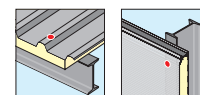
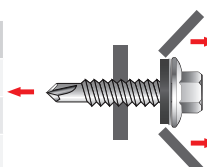
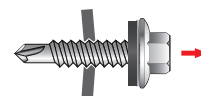
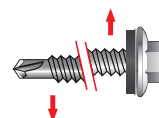
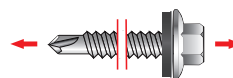

Drive Tool



Self-drilling fastener range

Certifications



ETA-13/0177

Figures shown on this data sheet are based on results obtained from tests carried out in EJOT UK's Applitec laboratory in accordance with equipment conforming to current industry standards, on a random sample of fasteners manufactured to EJOT tolerances. Information supplied should form part of a general guide and should performance data for a specific application be required please do not hesitate to contact us.

EJOT UK Ltd, Hurricane Close, Sherburn-in-Elmet, Leeds LS25 6PB.