

## FBS-R 6.3 x L range

Case hardened carbon steel concrete anchor, with low profile button head, designed for fastening insulation back to concrete.

### Application Features

- Fastener embedment 30 - 45 mm
- Can be used in conjunction with the EcoTek tube washer, HTV 82/40F, HTV 40RU, and flat roof profile FP
- T30 drive
- Twin threads reduce installation torque
- Requires a 5.0mm diameter pilot hole 40 - 55mm deep

### Material Specification

- High quality case hardened low carbon steel manufactured in accordance with BS EN ISO 10666.



### Performance Details

#### Ultimate Fastener Tensile Strength

Fastener Diameter	kN
6.3 x L	18.40

#### Ultimate Fastener Shear Strength

Fastener Diameter	kN
6.3 x L	12.2

#### Ultimate Pullout Load kN

Fastener Diameter	Embedment (mm)	
	30	45
6.3 x L	8.50	18.00

Figures based on pullout testing conducted from concrete of grade C20/C25 as per EN 1992-1-1:2004. These data are indicative and should be used for guidance only. Onsite tests are recommended to verify data.

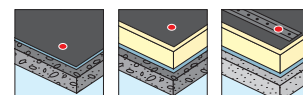
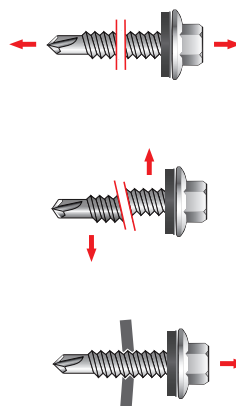

#### Drive Tool



Self-tapping fastener range

#### Certifications



ETA-07/0013

Figures shown on this data sheet are based on results obtained from tests carried out in EJOT UK's Applitec laboratory in accordance with equipment conforming to current industry standards, on a random sample of fasteners manufactured to EJOT tolerances. Information supplied should form part of a general guide and should performance data for a specific application be required please do not hesitate to contact us.