

## **EJOT® self-drilling screw JT6-2/5-5.0 VARIO**

Reliable fixing of sliding and fixed points on substructures of rear ventilated facades

## **EJOT® self-drilling screw JT6-2/5-5.0x30-VARIO –**

### **Fixing wall brackets to support profiles**

For fastening pre-drilled wall brackets to support profiles, EJOT has developed a universal fixed and sliding point screw made of A4 stainless steel. The usability of all possible component combinations and their characteristic load-carrying capacity values are regulated in a general building inspection certificate (P-BWU02-178002).

The applications range from wall brackets made of stainless steel with a thickness of  $\geq 1.5$  mm up to wall brackets made of aluminium with a thickness of 3.0 to 5.0 mm. The support profile may vary from 2.0 to 3.0 mm.

The functional principle of the screw stipulates that the connection is only subjected to moderate contact pressure, by means of a buffer zone between the screw head and a flat stainless steel sliding disk. This always provides for a forcing tension-free sliding of the connection.

The detail point is rigid irrespective of the component combinations. In the installation sequence, this facilitates the fastening of the facade cladding to the support profiles. The defined sliding of the connection reduces disturbing stress noise of the construction.

This fastener uses tried and tested bi-met technology with a hardened carbon steel drill point. This results in an extremely high drilling performance, even with only moderate contact pressure of the drill point on the supporting profile.

The low pitch thread enables precise control of the fastener during the installation process. This aids the installer to correctly compress the washer in the buffer zone, allowing for required movement within the system. For fastening, EJOT recommends using the A/F8 VARIO tool with depth control.

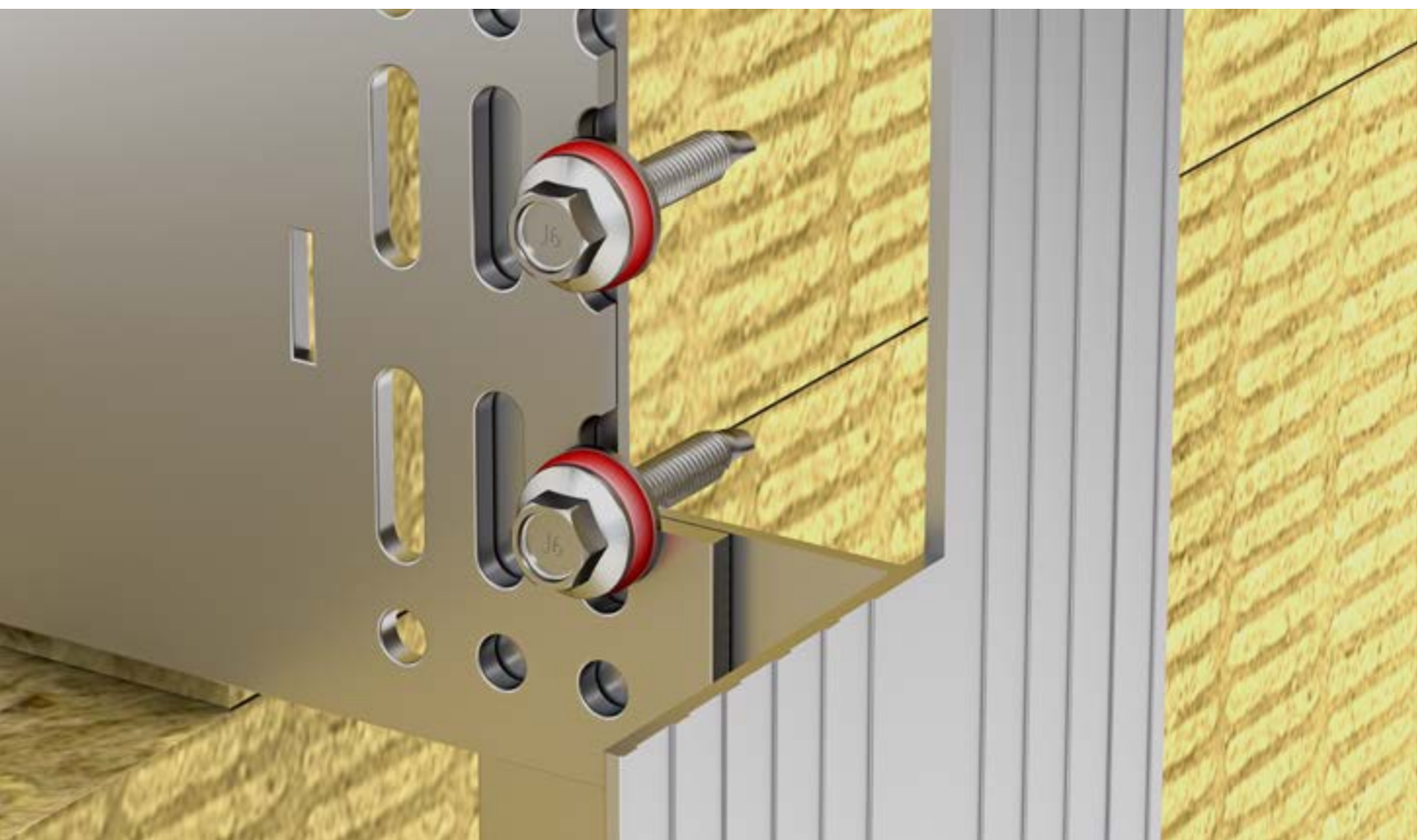

## Facade fasteners

For rear ventilated facades (VHF)

**EJOT®**

### The product advantages at a glance

- One screw for all part combinations
- Consistently low contact pressure prevents stick-slip phenomenon
- No stripping/destruction of the thread in the substructure, resulting in high tensile loading capacity
- High self-locking / clamping effect of the thread in component II due to reduced drill point diameter
- No loosening of the screw under long-term stress
- High tensile and transverse load transmission in the substructure due to fine pitch thread
- General building authorities test certificate as proof of usability according to DIN 18516-1
- The test certificate includes aluminium and stainless steel wall brackets
- Buffer zone compensates skew position of the screw
- Case hardened drill point for fastening in steel support profiles (not part of the test certificate)
- With strongly reduced rotation speed it is also suitable for support profiles made of 2 mm stainless steel (not part of the test certificate)

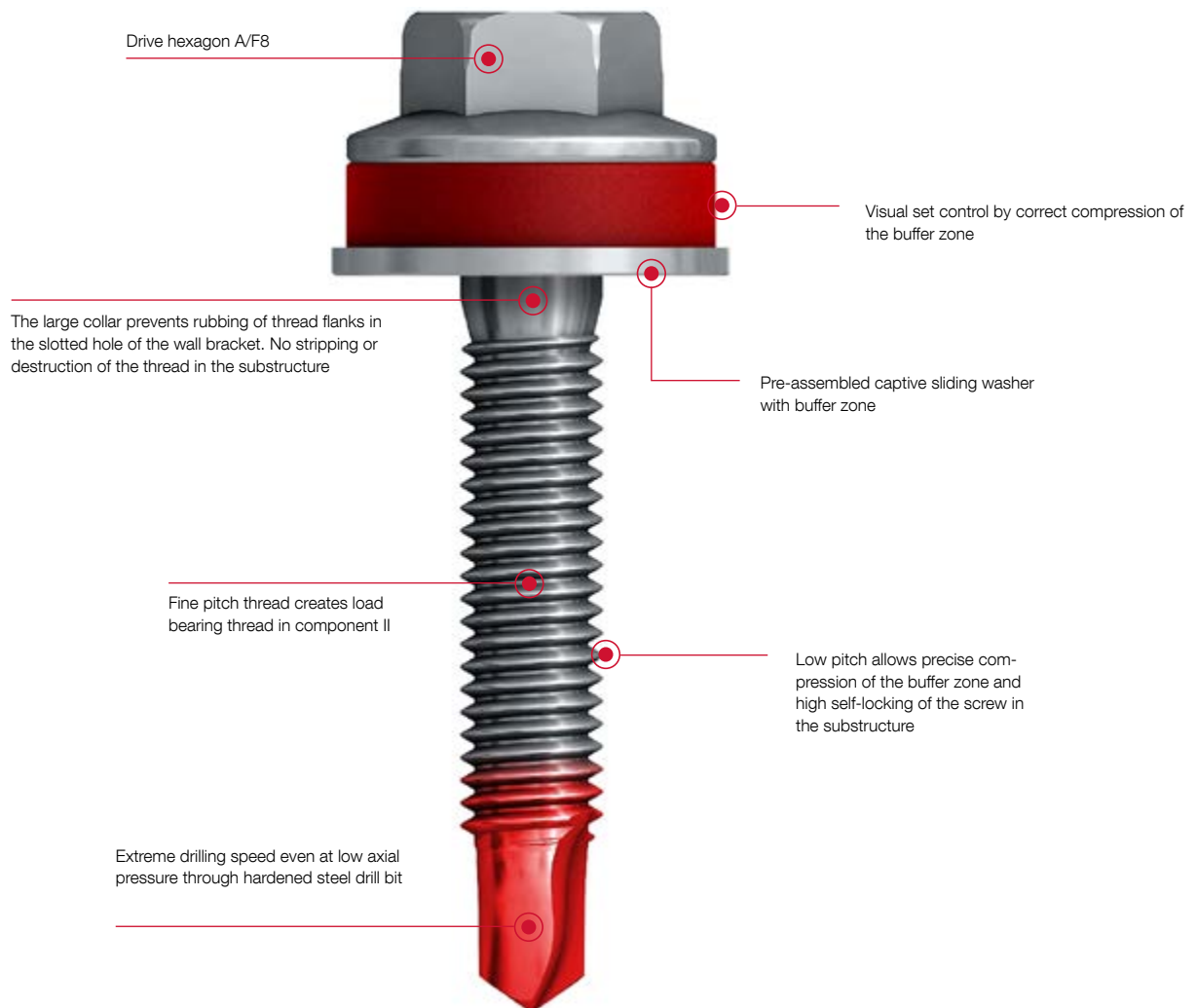

## Easy to install: Visual set control and broad application range

The new EJOT® SUPER-SAPHIR self-drilling screw JT6-2/5-5.0x30-VARIO features a visual set control and is fastened to the visual limit stop. This results in advantages over conventional sliding and fixed-point screws, which have to be stripped in a controlled manner.

Sliding and fixed point screws that have to be stripped in a controlled manner, feature either a free spin zone or a continuous thread up to the screw head.

Screws with an undercut must be exactly matched to the thickness of the respective wall bracket, so the range of application is limited per free spin zone screw.

Screws with a continuous thread require a high degree of expertise from the installer. In addition, he must take into account a different assembly process between sliding and fixed point. In order to achieve an installation without forcing tension at the sliding point, the screw with continuous thread must be rotated few turns further after the screw head rests on the wall bracket. This is not required when forming a fixed point.

With the new EJOT® JT6-2/5-5.0x30-VARIO the installation is much simpler and process reliable. Due to the optical set control, installers and site managers can directly identify whether the screw has been correctly installed.

To prevent faulty installation, EJOT also recommends the use of the A/F8 VARIO tool with depth control. This will set the washer correctly every time with no over-driving. The fastener is installed the same way for fixed point and sliding point applications.

### Free spin zone

The free spin zone is a threadless area underneath the screw head. This is a geometric change in the fastener shank diameter, in which the shank is smaller than or equal to the thread core diameter. This special shape prevents unintended turning back of the screw.

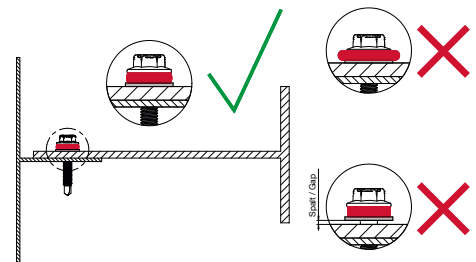

### Operating principle of the A/F8 VARIO tool with depth control

1. VARIO screw is captively inserted into the tool
2. VARIO screw is screwed into supporting profile
3. Tool is applied with depth control on wall bracket
4. VARIO screw is screwed-in further
5. Optimum compression of the EPDM is achieved, at the same time the fastening process stops as the tool no longer generates force

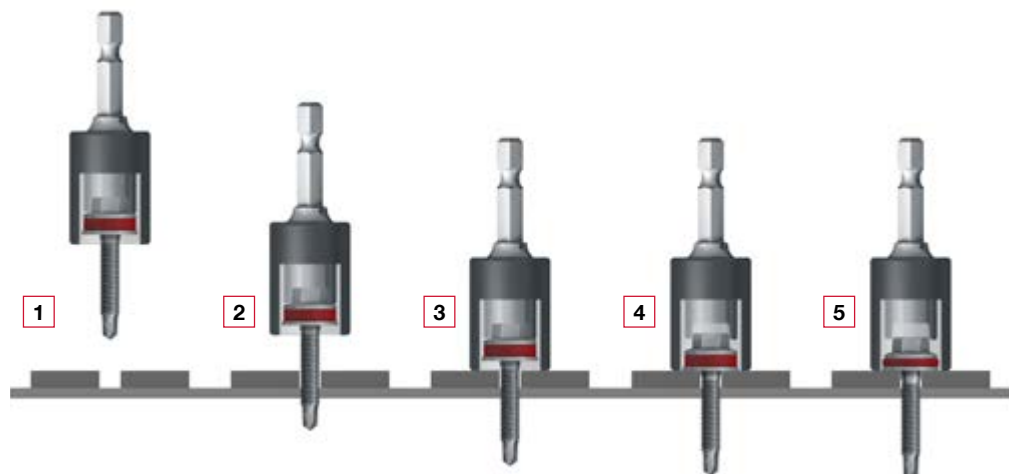

## Wall bracket under pressure

Very high forces can act on the substructure until finally the desired sliding of the components occurs. This force can have a critical effect on the tensile load in the anchoring base, especially in the case of long wall brackets.

The EJOT® JT6-2/5-5.0x30-VARIO reduces the effect of the force by a constant low contact pressure.

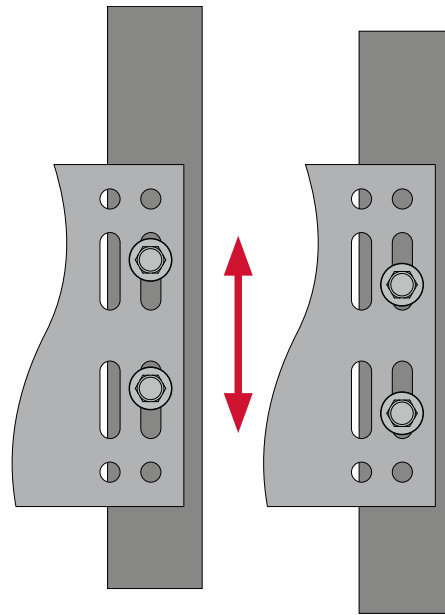

## Required force needed for the sliding of the connection

Example: aluminium wall bracket (4 mm) to aluminium bearing profile (3 mm)

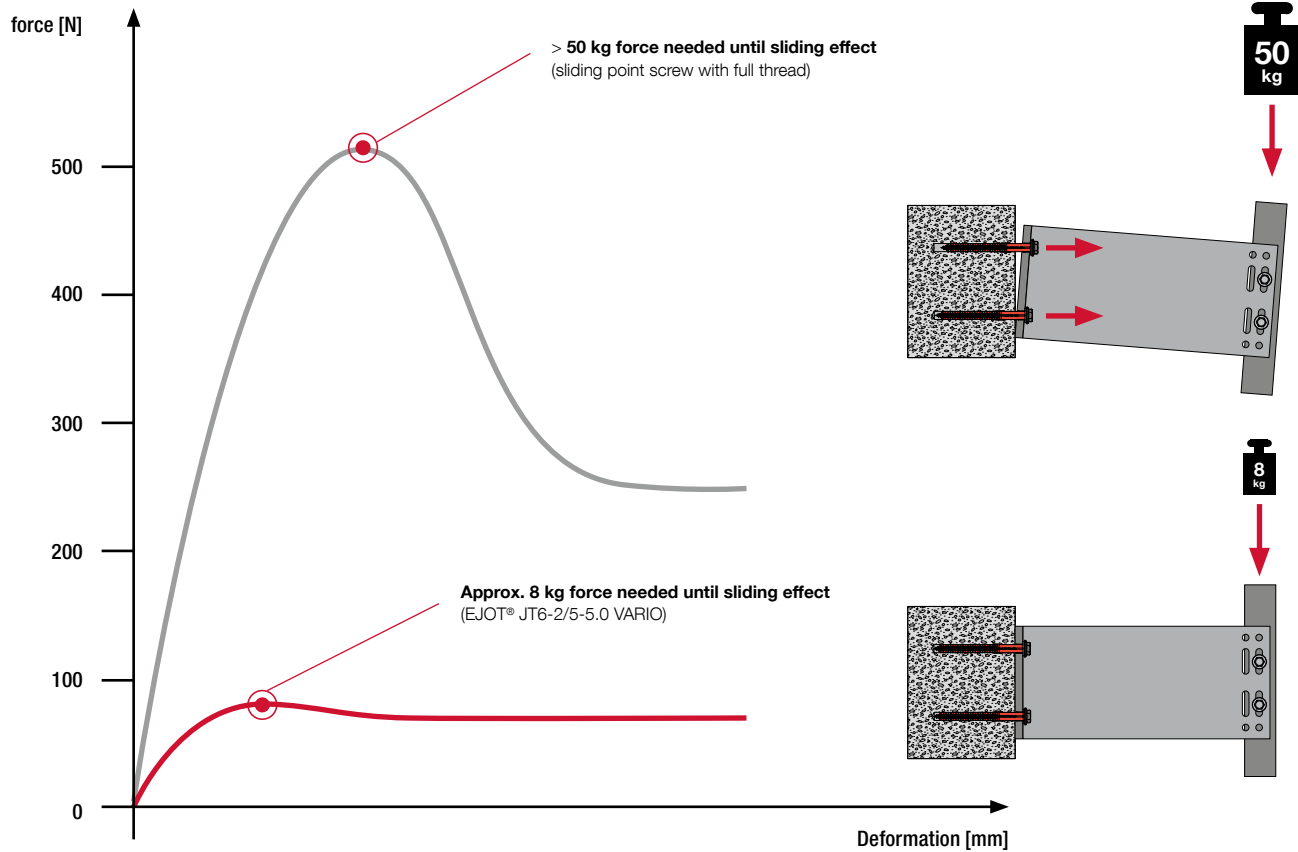



**EJOT® SUPER-SAPHIR self-drilling screw JT6-2/5-5.0 VARIO**

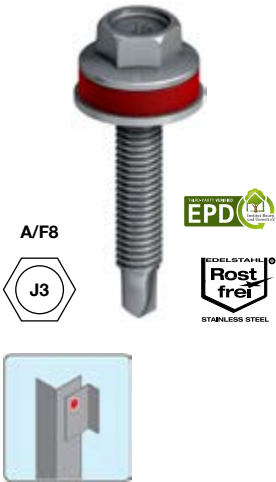

Ø [mm]	Length [mm]	PU	Price/100 [EUR]	Order description	Article number
<b>Sliding washer E14, Ø 14 mm</b>					
5.0	30	500	-	JT6-2/5-5.0x30-VARIO*	3 598 077 991

\*JT9 as full stainless steel version upon request

**Application range**

- To form sliding and fixed points on sub-structures of rear ventilated facades
- Fastening pre-drilled stainless steel or aluminium wall brackets to aluminium support profiles

**Features**

- A4 stainless steel with hardened drill point
- Buffer zone between the screw head and sliding disk prevents excessive clamp load of the joint
- Pre-assembled captive sliding washer

**Technical specifications**

Drilling capacity	3.0 mm
Drive	Hexagon A/F8



**Test certificate**  
P-BWU02-178002

**Cross-reference**  
A/F8 VARIO Tool  
Cordless screwdriver ASCS 6.3

**Possible part combinations**  
Stainless steel wall bracket

Component I [mm]	Comp. II [mm]	Total t <sub>i</sub> + t <sub>ii</sub> [mm]	R <sub>m</sub> support profile/ Wall bracket		
1.5 (stainless steel)	2.0	3.5	≥ 190 N/mm <sup>2</sup>		
	2.5	4.0			
	3.0	4.5			
	2.0 (stainless steel)	2.0	3.5	≥ 215 N/mm <sup>2</sup>	
		2.5	4.0		
		3.0	4.5		
		2.5	2.0	3.5	≥ 245 N/mm <sup>2</sup>
			2.5	4.0	
			3.0	4.5	
2.0 (stainless steel)	2.0	4.0	≥ 190 N/mm <sup>2</sup>		
	2.5	4.5			
	3.0	5.0			
	2.0 (stainless steel)	2.0	4.0	≥ 215 N/mm <sup>2</sup>	
		2.5	4.5		
		3.0	5.0		
	2.5	2.0	4.0	≥ 245 N/mm <sup>2</sup>	
		2.5	4.5		
		3.0	5.0		
3.0 (stainless steel)	2.0	5.0	≥ 190 N/mm <sup>2</sup>		
	2.5	5.5			
	3.0	6.0			
	2.0 (stainless steel)	2.0	5.0	≥ 215 N/mm <sup>2</sup>	
		2.5	5.5		
		3.0	6.0		
	2.0	2.0	5.0	≥ 245 N/mm <sup>2</sup>	
		2.5	5.5		
		3.0	6.0		

**Possible part combinations**  
Aluminium wall bracket

Component I [mm]	Comp. II [mm]	Total t <sub>i</sub> + t <sub>ii</sub> [mm]	R <sub>m</sub> support profile/ Wall bracket		
3.0 (aluminium)	2.0	5.0	≥ 190 N/mm <sup>2</sup>		
	2.5	5.5			
	3.0	6.0			
	3.0 (aluminium)	2.0	5.0	≥ 215 N/mm <sup>2</sup>	
		2.5	5.5		
		3.0	6.0		
		2.0	2.0	5.0	≥ 245 N/mm <sup>2</sup>
			2.5	5.5	
			3.0	6.0	
4.0 (aluminium)	2.0	6.0	≥ 190 N/mm <sup>2</sup>		
	2.5	6.5			
	3.0	7.0			
	4.0 (aluminium)	2.0	6.0	≥ 215 N/mm <sup>2</sup>	
		2.5	6.5		
		3.0	7.0		
	2.0	2.0	6.0	≥ 245 N/mm <sup>2</sup>	
		2.5	6.5		
		3.0	7.0		
5.0 (aluminium)	2.0	7.0	≥ 190 N/mm <sup>2</sup>		
	2.5	7.5			
	3.0	8.0			
	5.0 (aluminium)	2.0	7.0	≥ 215 N/mm <sup>2</sup>	
		2.5	7.5		
		3.0	8.0		
	2.0	2.0	7.0	≥ 245 N/mm <sup>2</sup>	
		2.5	7.5		
		3.0	8.0		



**Watch the video now:**  
<https://youtu.be/yL0yRtO9BJc>



**Cordless metal screwdriver ASCS 6.3 Select**

Order description	PU	Price/1 [EUR]	Article number
Cordless screwdriver ASCS 6.3 Select	1	249.00	9 150 200 003

**Application range**

- Torque optimised cordless screwgun for fixing metal with screw diameters of up to 6.3 mm

**Features**

- Powerful battery for over 150 fixings in sheet steel
- Electronic torque shut-off for precise results even without depth control
- Maintenance-free, brushless motor with a very high degree of efficiency
- Tested for over 500,000 single fixings
- Over 1000 recharge cycles per battery pack
- Extremely low weight
- Optimum ergonomics with pistol handle for high contact pressure
- Powerful up to 30 Nm

**Technical specifications**

Battery voltage	18 V
Load speed	0-1500 rpm
Idle speed	0-1700 rpm
Max. torque (hard/soft)	30/10 Nm
Quick change chuck	1/4"
Screws	Ø 6.3 mm
Battery pack	X



**Included in delivery**

- 1 ASCS 6.3 (without battery pack or battery charger)
- 1 plastic tool case
- 1 scaffolding anchor
- 1 depth control
- 1 socket for hexagon screws A/F8

**Battery packs and chargers**

Order description	PU	Price/1 [EUR]	Article number
Battery Starter-Set 18V / 2.5 Ah*	1	177.00	9 154 200 014
Battery Starter-Set 18V / 5.0 Ah*	1	237.00	9 154 200 015
Rapid charger ALG 50	1	39.00	9 152 200 006
Rapid charger ALG 30	1	136.00	9 154 200 006
Battery Pack 18V / 2.5 Ah	1	69.00	9 154 200 004
Battery Pack 18V / 5.0 Ah	1	99.00	9 154 200 005

\*Every Starter-Set includes two Li-Ion batteries and a battery charger



**EJOT® A/F8 VARIO Tool**

Order description	PU	Price/1 [EUR]	Article number
A/F8-Vario Tool	1	8.50	9 152 900 000

**Application range**

- For the reliable fastening of JT6-2/5-5.0 VARIO

**Advantages**

- Fastener does not buckle to the side

**Features**

- Easy handling
- Optimum installation in any position
- Reliable screw guidance





**EJOT Baubefestigungen GmbH**

In der Stockwiese 35

57334 Bad Laasphe, GERMANY

Phone: +49 2752 908-0

Fax: +49 2752 908-731

E-Mail: [bau@ejot.de](mailto:bau@ejot.de)

Internet: [www.ejot.com](http://www.ejot.com)