

EJOT Super-SAPHIR® Self-Drilling JT3-2-5.6 Timber Range

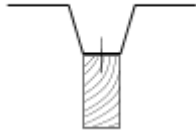

Ultimate Fastener Tensile Strength

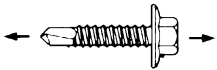

Fastener Dia	kN
5.6 x L	11.70

Ultimate Fastener Shear Strength

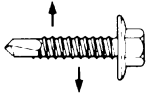

Fastener Dia	kN
5.6 x L	8.80

Ultimate Pullout Load kN

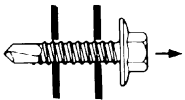

Fastener Dia	Timber Embedment (mm)	
	25	30
5.6 x L	2.15	3.15

Figures based on tests from construction grade timber and are average figures from pulls made from different surfaces relevant to grain of timber.

Ultimate Pullover Load kN

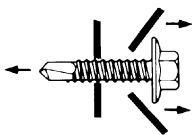

Washer Face	Nominal Sheet Thickness (mm)				
	Steel			Aluminium	
	0.50	0.70	0.90	0.70	0.90
S16 Washer	4.20	5.20	5.50	2.00	2.20
S19 Washer	4.50	5.65	6.00	2.40	2.90

Figures based on use with R38 profile steel sheets with fastener located in valley of profile and tested in accordance with BS 5427

Figures above are based on results obtained from tests carried out in our Applitec lab in accordance with equipment conforming to BS 5427 on a random sample of fasteners manufactured to EJOT tolerances. Information supplied should form part of a general guide and should performance data for a specific application be required please do not hesitate to contact us.

EJOT UK Limited Sherburn-in-Elmet, Leeds LS25 6PB.
Tel: 01977 687040 Fax: 01977 687041
www.ejot.co.uk info@ejot.co.uk

Material Specification

Fastener

High quality Stainless steel grade 304 St/St, ISO group A2, Din Werkstoff 1.4301.

Drill Point

High quality grade casehardened carbon steel to Din standard 10666.

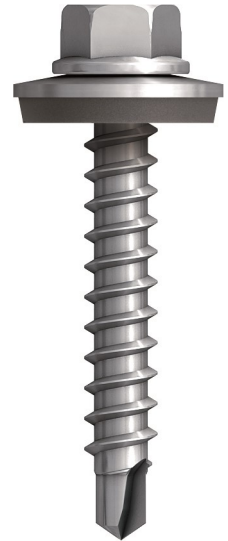

8mm Hex