

Stress plate-HTV-40-RU

Galvanised carbon steel plate for load spreading when fixing insulation.



Application Features

- To fix roofing membrane and to fasten pressure-resistant insulation to substructures made of trapezoidal steel profiles, timber, wood-based materials, concrete and aerated concrete

Material Specification

- Alu-zinc-coated steel
- Note: compatible with EJOT Dabo® screws / with concrete and aerated concrete screws

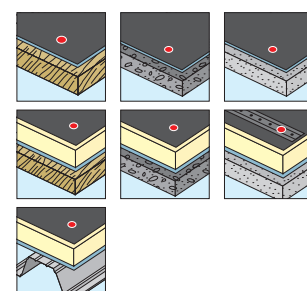

Certifications



ETA-07/0013

Figures shown on this data sheet are based on results obtained from tests carried out in EJOT UK's Applitec laboratory in accordance with equipment conforming to current industry standards, on a random sample of fasteners manufactured to EJOT tolerances. Information supplied should form part of a general guide and should performance data for a specific application be required please do not hesitate to contact us.